

REV	ECO	DWN	DATE
B	20135688	CJS	17-JUN-03
C	20239459	AED	07-MAY-08

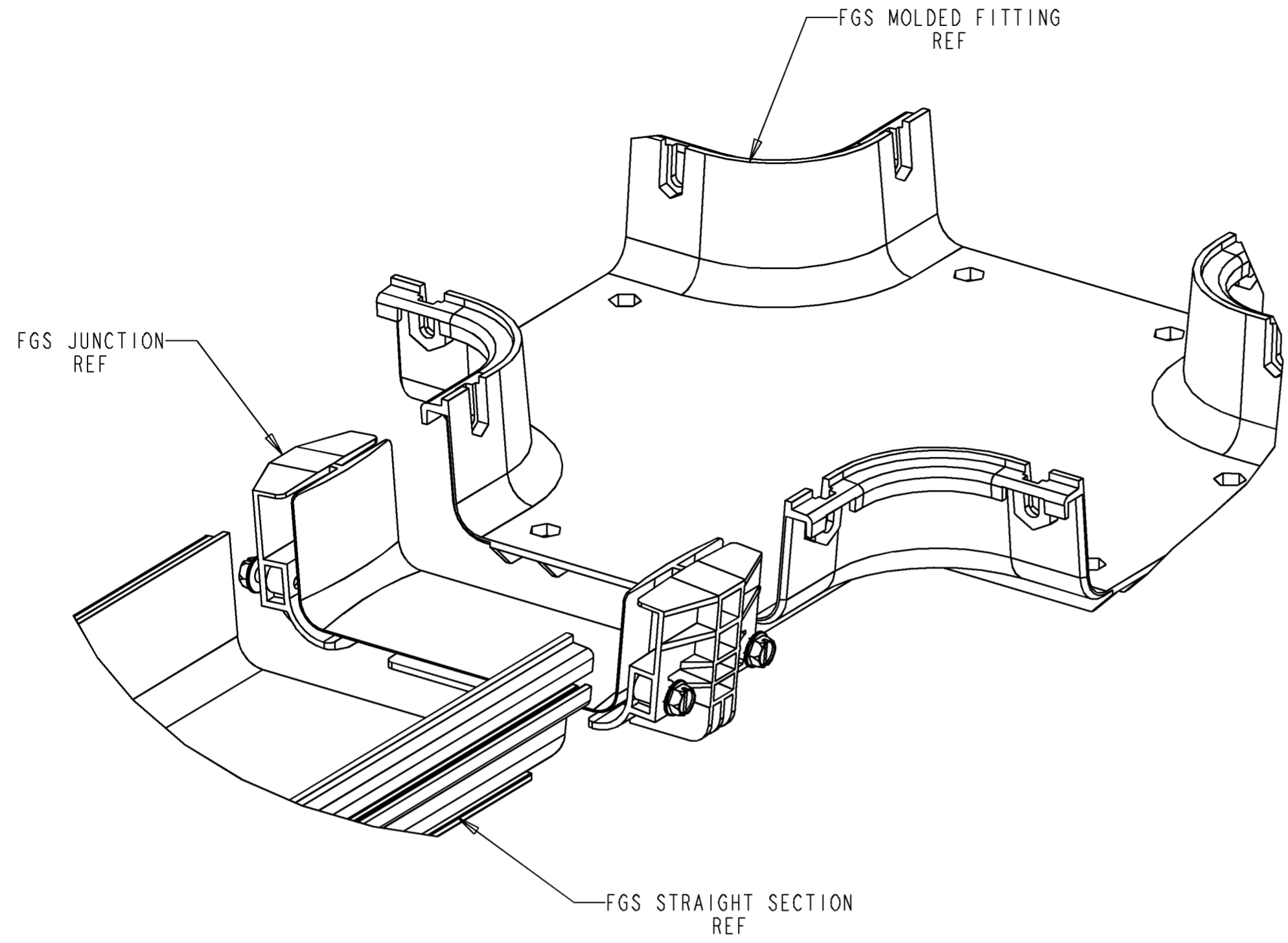

FIGURE 1

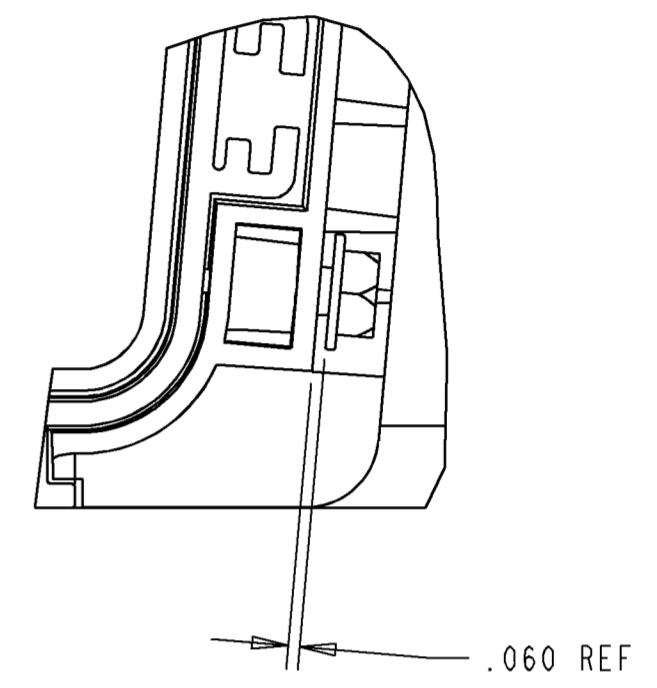
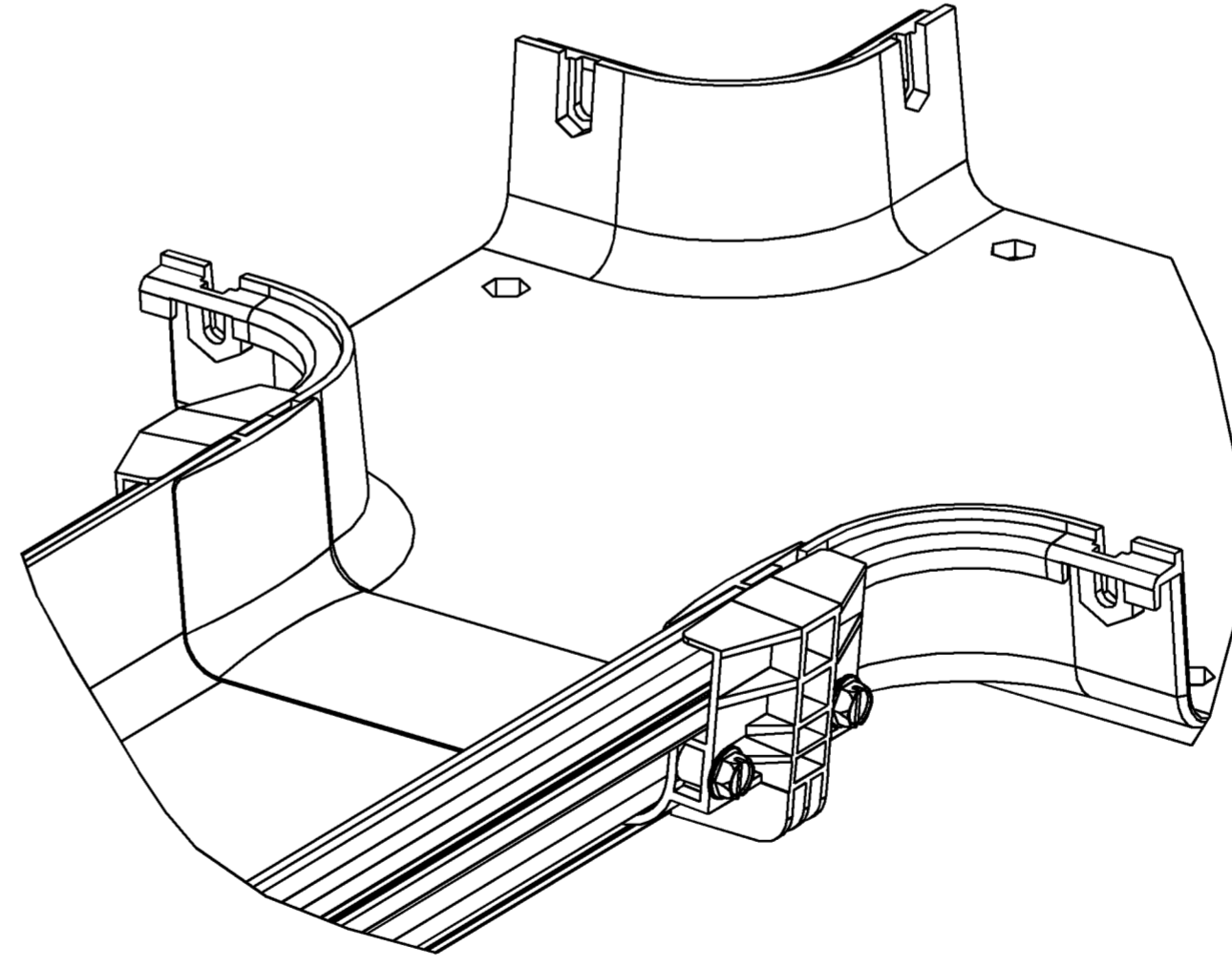

FIGURE 2  
INITIAL TIGHTENING  
TYP (4) PLACES  
SCALE 1.000



COMPLETED ASSEMBLY

INSTALLATION INSTRUCTIONS:

1. SLIDE BOTH FGS COMPONENTS INTO JUNCTION UNTIL FIRMLY SEATED AGAINST THE CENTER RIB.
2. TIGHTEN (4) SCREWS SUCH THAT THE WASHER HEAD ON SCREW IS APPROXIMATELY 1/16" FROM JUNCTION (SEE FIGURE 2). AFTER ALL SCREWS HAVE BEEN TURNED INTO 1/16" DIMENSION, GO BACK AND TIGHTEN SCREWS UNTIL THE WASHER HEAD BOTTOMS OUT ON THE JUNCTION.

FGSB-JUNC-G	BLACK
FGSS-JUNC-G	SMOKE
FGSO-JUNC-G	ORANGE
FGS-JUNC-G	YELLOW
CATALOG NUMBER	COLOR



INFORMATION ON THIS DOCUMENT IS PROPRIETARY TO ADC AND SHALL NOT BE USED, COPIED, REPRODUCED OR DISCLOSED IN WHOLE OR IN PART WITHOUT WRITTEN CONSENT OF ADC.

ALL DIMS AND TOLERANCES ARE INCHES UNLESS OTHERWISE SPECIFIED  
 .XX:±.XX  
 .XXX:±.XXX  
 ANGULAR:±N/A

TITLE: INSTALLATION DRAWING  
 JUNCTION, FGS, 2X6

DRAWING NUMBER: 1171141

DO NOT SCALE DRAWING

ENGR: JOHN VAN SCOY  
 DWN: WAYNE GIESEN

SHT. 1 OF 1

DIMENSIONS IN INCHES  
 THIRD ANGLE PROJECTION