

MR050B-KIT-CPRSR

MR050B Compressor Replacement

1. Cut the wires from the compressor half way between the compressor and the controller board. Remove the old compressor from its mount.
2. Strip the leads of the wires coming from the controller board.
3. Install the new compressor as shown using the standoffs, compressor grommets, #8 flat washers and #8-32 lock nuts. Crimp the wire splices attached to the new compressor's wires to the newly-spliced controller wires.

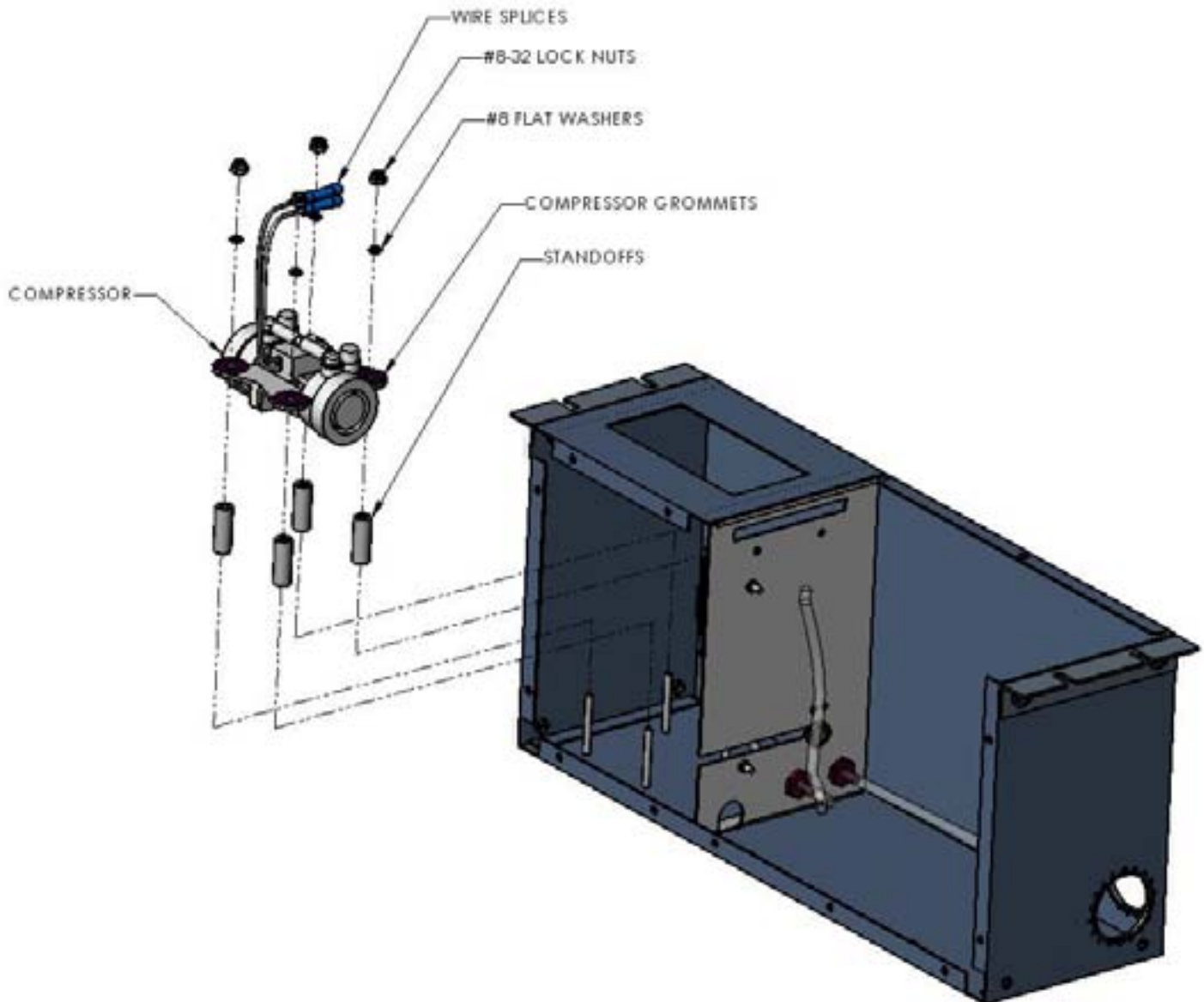



**Customer Support Center
From North America**
Telephone: 1-800-255-1479
Fax (U.S.A.): 1-800-349-5444

International
Telephone: +1-779-435-6500
Fax Number: +1-779-435-8579

Web Access
Internet: www.commscope.com
Email: #prc@commscope.com

All designs, specifications and availability of products and services presented in this bulletin are subject to change without notice.

Bulletin AE01B-A0549-002 (09/11) Rev B © 2008 - 2011 CommScope, Inc. All rights reserved
CommScope, 3 Westbrook Corporate Center, Suite 900 Westchester, IL 60154 USA