

MT500A-KIT-FLTRS
MT500A Filter Bowl Replacement Kit

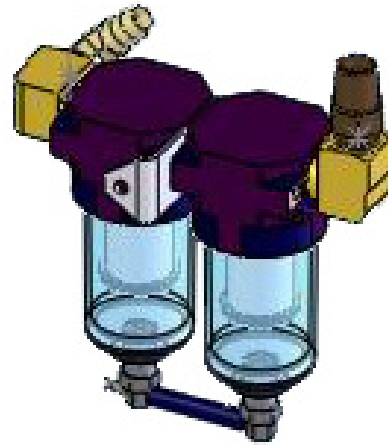

Cable Tie



Filter Bowl Assembly



9/16
Hose Clamp



1/4
Hose Clamp

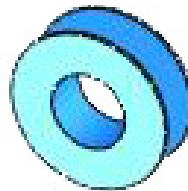

Teflon Tape

FILTER BOWL REPLACEMENT KIT INCLUDED PARTS

FILTER BOWL ASSEMBLY REPLACEMENT

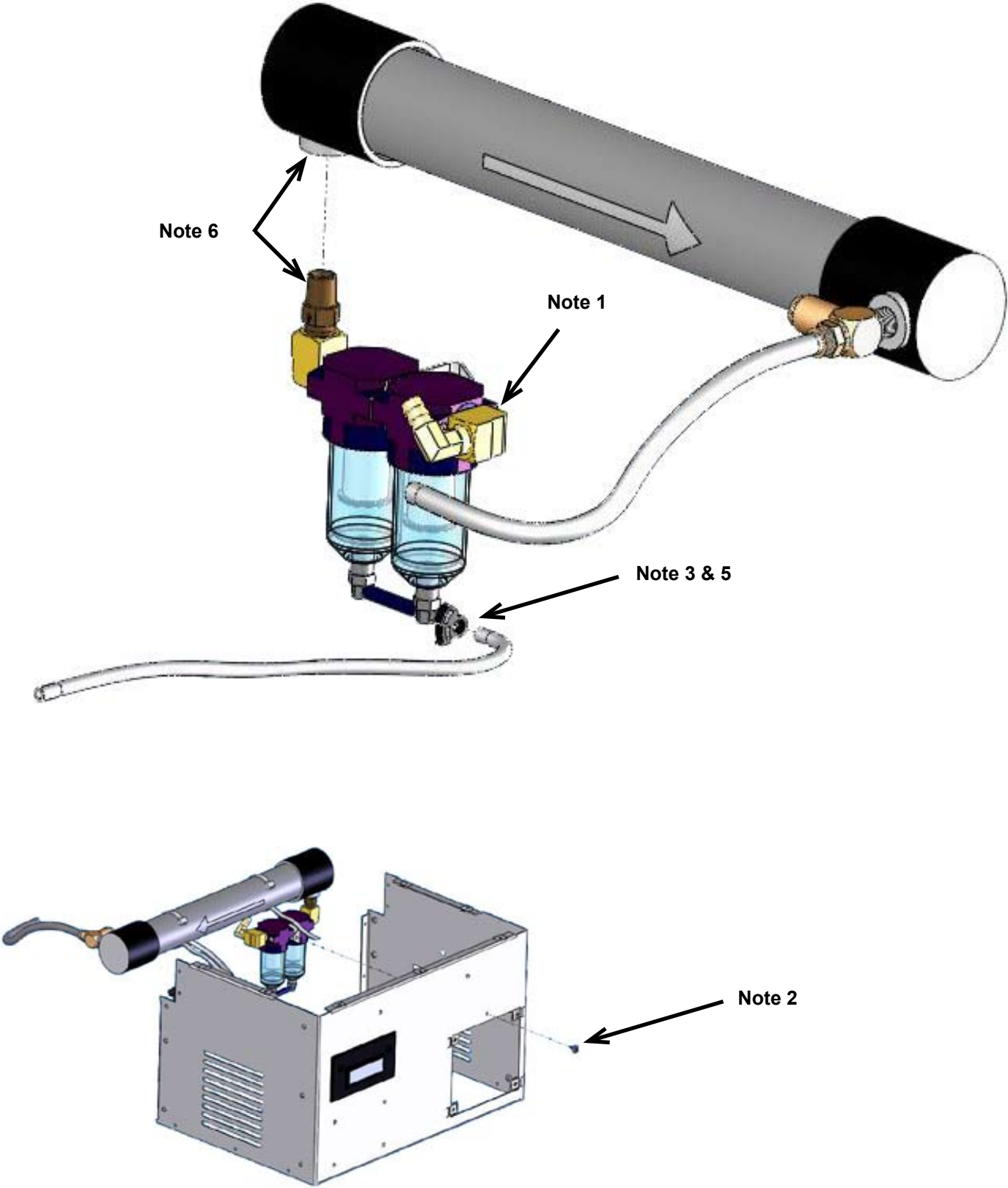

FILTER BOWL ASSEMBLY REPLACEMENT

1. Remove the high-temp hose going from the heat exchanger to the filter bowl inlet barb by removing the filter-end clamp.
2. Remove the screw holding the filter bowl assembly to the chassis.
3. Remove the 1/4" hose from the filter bowl drain on the bottom of the filter bowl assembly.
4. Cut the plastic ties that hold the membrane to the chassis and remove the filter bowl and membrane assembly.
5. Press the 1/4" hose onto the new filter bowl drain output and 1/4" clamp as shown.
(There is 1' of 1/4" tubing in the kit if need to replace tubing.)
6. Wrap the threaded end of the check valve on the filter bowl assembly with Teflon tape. Screw the new filter bowl assembly into the input side of the membrane as indicated.
7. To re-install, reverse the removal steps. Use the new clamps that are provided in the kit.



MT500A-KIT-FLTRS

MT500A Filter Bowl Replacement Kit



3 Westbrook Corporate Center
Suite 900
Westchester, IL 60154 USA

One Company. A World of Solutions.

**Customer Support Center
From North America**
Telephone: 1-800-255-1479

International
Telephone: +1-779-435-6500

Internet: www.andrew.com

All designs, specifications and availability of products and services presented in this bulletin are subject to change without notice.

Bulletin AE01B-A0531-003 (5/07) © 2007
Andrew Corporation, 3 Westbrook Corporate Center, Suite 900 Westchester, IL 60154
USA