

EQ-P0410-B

Equipment Platform, 4 ft x 10 ft, base only

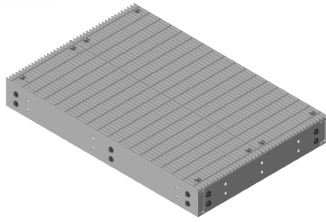

Product Classification

Product Type Equipment platform system

Dimensions

Length 1219.2 mm | 48.0 in
Width 3048.0 mm | 120.0 in
Height 203.2 mm | 8.0 in
Weight 351.6 kg | 775.1 lb

Environmental Specifications

Load Capacity Up to 10,000 lb (4536 kg) loading

General Specifications

Includes Frame | Grating | Hardware
Legs, quantity 0
Material Type Hot dip galvanized steel
Package Quantity 1

Regulatory Compliance/Certifications

Agency ISO 9001:2015
Classification Designed, manufactured and/or distributed under this quality management system

