

ITEM	PART NO.	DESCRIPTION	QTY.	WEIGHT
1	MTC79020407.02	4' CENTER CHANNEL	7	40.85 LBS
2	MTC79021020.01	20' SIDE CHANNEL	2	227.29 LBS
3	MTC7902.03	CHANNEL ADAPTER ANGLE	14	7.07 LBS
4	MTC7902042002	Grating Section Bracket 4' Wide Platform	1	20.70 LBS
5	GB-05205	5/8" X 2" GALV BOLT KIT	59	0.27 LBS
6	GWF-05	5/8" GALV FLAT WASHER	118	0.06 LBS
7	MTC9170.09	24" X 120" BAR GRATING	4	141.45 LBS
8	GCM03	GRATING CLIP	24	0.39 LBS

REVISIONS				
REV.	ZONE	DESCRIPTION	BY	DATE
A		INITIAL RELEASE	MSM	04/04/12

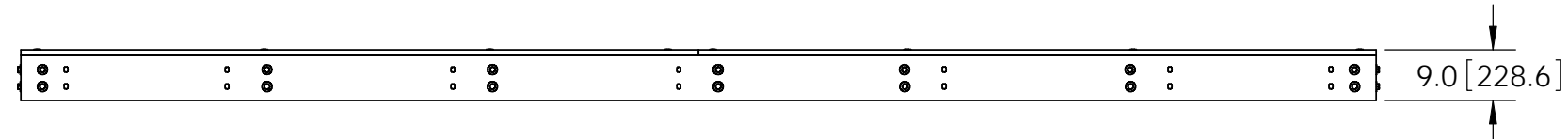
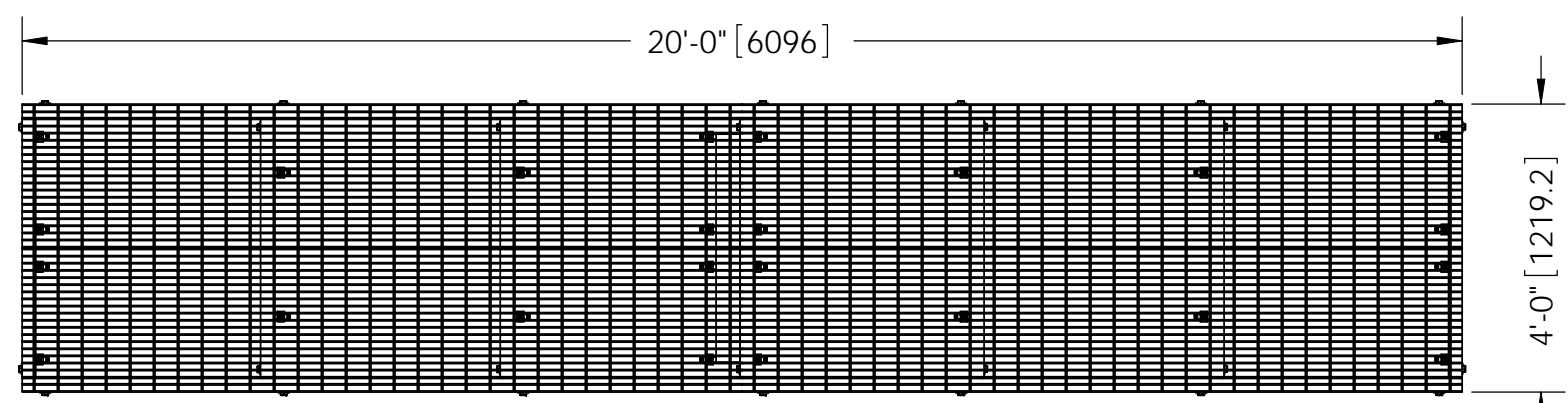
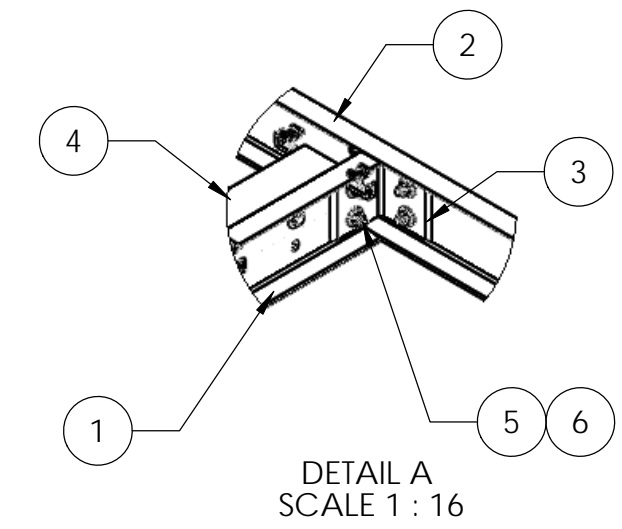
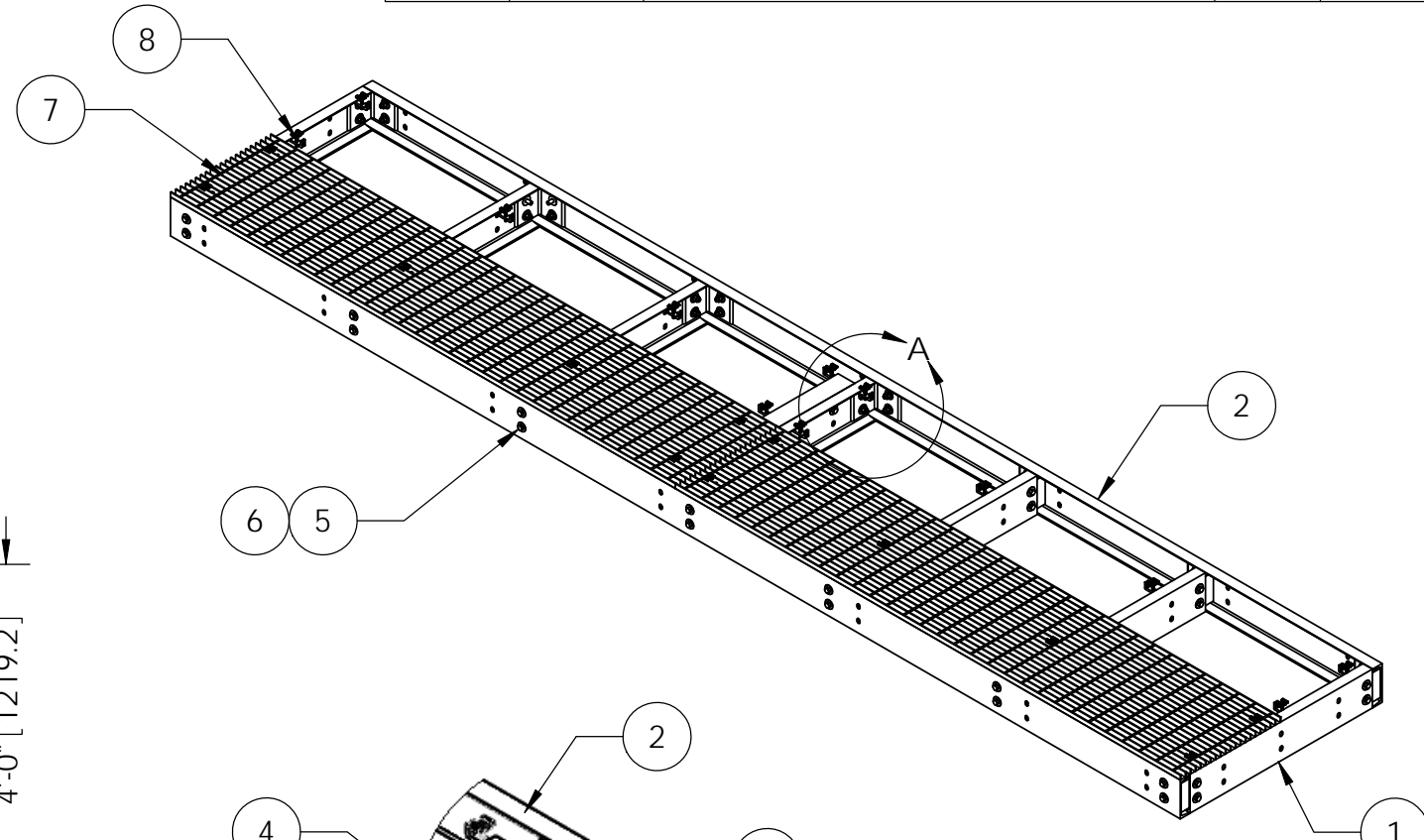

NOTES:
 1. ALL METRIC DIMENSIONS ARE IN BRACKETS.
 2. GRATING REMOVED FOR CLARITY.

These drawings and specifications are the proprietary property of CommScope Inc. and may be used only for the specific purpose authorized in writing by CommScope Inc. ALL DIMENSIONS ARE IN INCHES U.S.O.S. TOLERANCES UNLESS OTHERWISE SPECIFIED: .X = ± .12 ANGLES ±2° .XX = ± .06 FRACTIONS ±1/32 .XXX = ± .03 REMOVE BURRS AND BREAK EDGES .005 DO NOT SCALE THIS PRINT	DRAWN BY: MSM	SHEET: 1 of 1	PART NUMBER: EQ-P0420-B
	CHECKED BY: TP	SCALE: NTS	DESCRIPTION: Platform Base, 4' X 20'
	DATE: 04/04/12	MATERIAL: A36, A568	DRAWING TYPE: ASSEMBLY DRAWING
	REVISION: A	FINISH: GALV A123	 Hickory, NC 28602 U.S.A.
	WEIGHT: 1464.04 LBS		